

1 2 3 4 5 6

A A

B B

C C

D D

E E

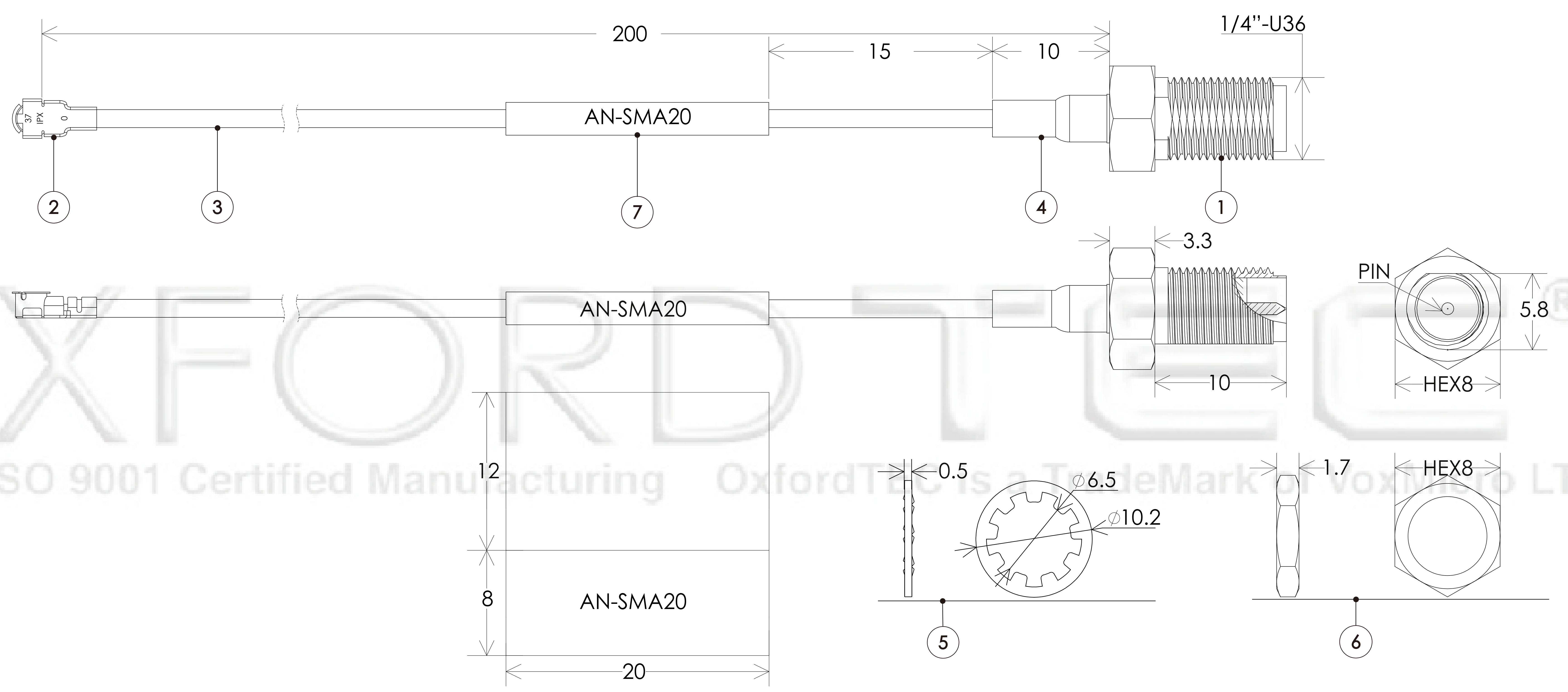
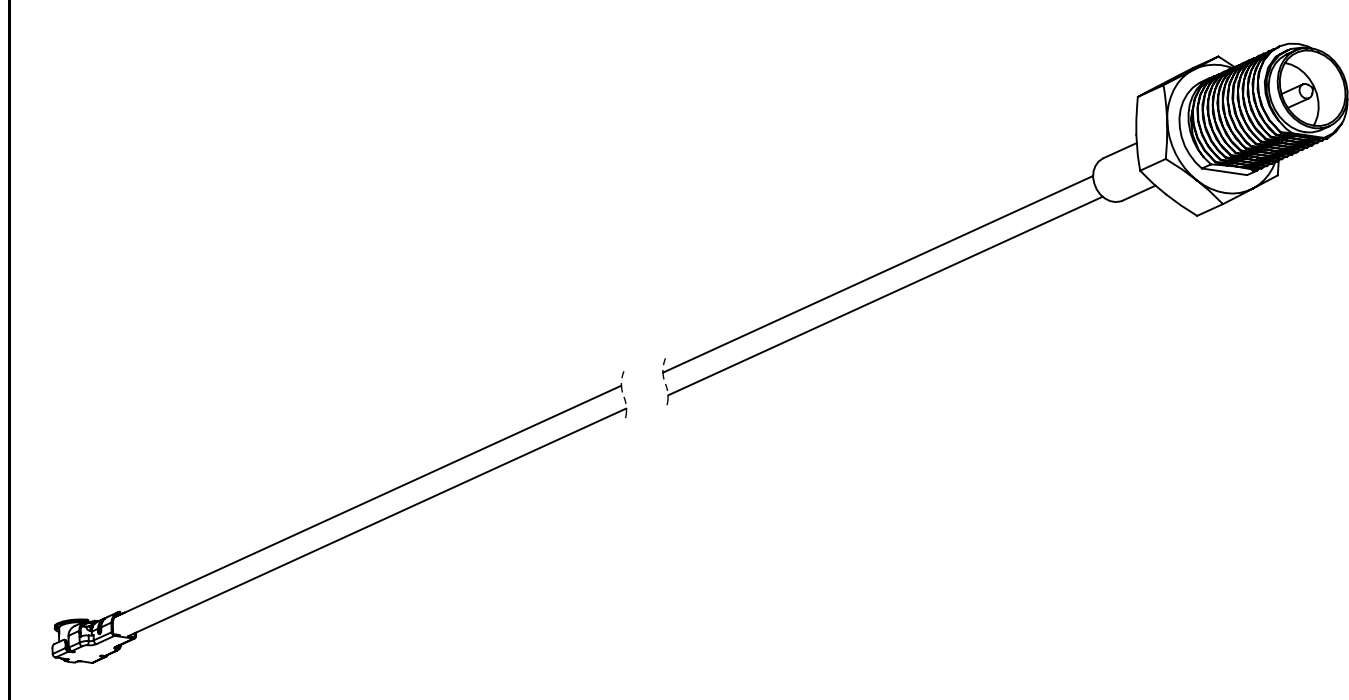

9					
8					
7	Cable Label		101-P1L20X8CA		1
6	Nut	Copper Brass	WA-SMAWNUT		1
5	Tooth Washer	Copper Brass	WA-SMAWASHER		1
4	Shrink Tube 3.0	EVA	black	VM05-030G03-BL	1
3	1.37 Coaxial	Silver Plated Copper Wire	black	VM02-137HAN-BL	1
2	1.37 IPEX R/A	Brass	Gold Plated	VM01-MHF137-HG	1
1	SMA Jack(Female)	Copper	Gold Plated	VM01-054SPC-GFM	1

**PART NUMBER** AN-SMA20  
**DESCRIPTION** U.Fl. male (IPEX) to RP-SMA (reverse polarity SMA) female pigtail cable



Copyright © All Rights Reserved - OXFORDTEC® - a registered trademark of VoxMicro LTD Group [www.voxmicro.com](http://www.voxmicro.com) - [www.voxmicro.tel](http://www.voxmicro.tel) - [www.oxfordtec.com](http://www.oxfordtec.com)

DRAWING NUMBER	FINISH by	APVD by	MATERIAL by	UNITS in	DIMENSION	SIZE	SCALE	SHEET
OEECP-098306-01	C. C.		L. T.	mm	1PCL ±0.5 ANGLES ±5	A4	1:1	1 OF 1

RELEASE	Zone	NOTES	DRAWN	CHECKED	DATE
1		New Release	C. C.	L. T.	2009-11-20

# DESCRIPTION MATERIAL FINISH VMIPN QTY

1 2 3 4 5 6