



L100x/L104x Series User Manual

Revision: R00
(10/2020)

Trademark

All brand and product names are trademarks or registered trademarks of their respective companies.

Disclaimer

Specifications and documents are subject to change without notice.

Note

Not all models are available in all regions.

Not all features are available on all models.

Depending on the specific model purchased, the colour and look of your device and accessories may not exactly match the graphics shown in this document. The screenshots and other presentations shown in this document are for reference only.

MiTAC Computer (Kunshan) Co., Ltd.

No. 269, 2nd Avenue, District A, Comprehensive Free Trade Zone, Kunshan, Jiangsu, China

Table of Contents

1. Device Basics	4
Getting to Know Your Device	4
Docking Station	4
Using the Battery	5
Installing and Removing the Battery	5
Charging the Battery	6
Using the Hot-swap Function	7
Using the Memory Card and Micro-SIM Card	8
Turning the Device On and Off	9
Turning On	9
Sleep Mode	9
Aeroplane Mode	9
Restarting the Device	9
Turning Off	9
Shutting Down	9
2. Getting Started	10
Using the Touch Screen	10
Rotating the Screen	11
Home Screen	11
Home Button	11
Status Bar	11
Desktop	12
Application Shortcuts and Widgets	12
Favourites Tray	12
Grouping Shortcuts in a Folder	12
Changing the Wallpaper	13
Quick Settings	13
Your Apps	13
App Permissions	13
Barcode Reader	14
Turning Barcode Reader On and Off	14
Using the Barcode Reader	14
About the Barcode Reader	14
Using the Keyboard	15
Basic Editing	15
Adding Your Email Accounts	16
Removing an Account	16
3. Connectivity	17
Cellular Data Connection	17
Wireless Network Connection	17
Connecting to a Wireless Network	17
Removing a Remembered Network	17
Bluetooth	18
Pairing with Another Bluetooth Device	18
Disconnecting a Bluetooth Connection	18

NFC	18
Turning NFC On and Off	18
Using NFC	18
4. Personalising Your Device	19
Settings Menu	19
Network & internet	19
Connected devices	20
Apps & notifications	20
Battery	20
Display	20
Sound	21
Storage	21
Security & location	22
Accounts	22
Accessibility	22
Digital Wellbeing & parental controls	22
Google	22
System	22
About phone	23
5. Reference	24
Specifications and Accessories	24
Specifications	24
Accessories	24
Troubleshooting	25
Caring for the Device	25
Cleaning and Disinfecting Guide	26
Regulatory Information	27
RCM	27
EAC	27
FCC	27
IC	27
CE	28
RF Exposure Information (SAR)	29
WEEE	29
Bluetooth	29
Safety Precautions	30

1. Device Basics

Getting to Know Your Device

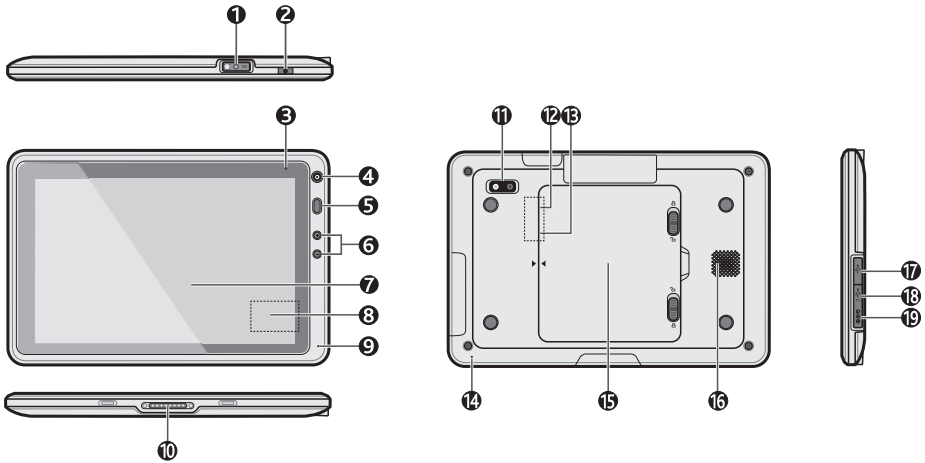

❶ Barcode reader*

❷ Power button

❸ Charge indicator

❹ Front camera lens

❺ Barcode reader button

❻ Volume buttons

❼ Touch screen

❽ NFC sensor

❾ Microphone

❿ Dock connector

⓫ Rear camera lens and flash LED

⓬ MicroSD card slot

⓭ Micro-SIM card slot*

⓮ Microphone

⓯ Battery cover

⓰ Speaker

⓱ USB Type A port

⓲ USB Type C connector

⓳ Power jack

* For selected models only.

Docking Station

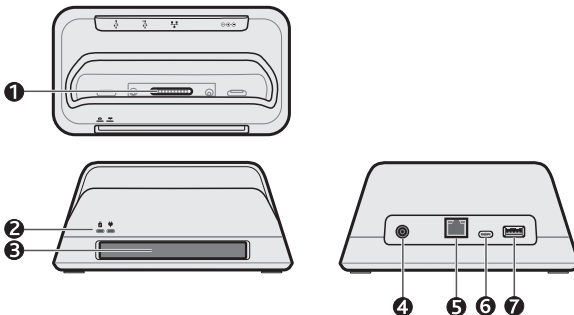

❶ Device connector

❷  Battery pack charge indicator

 Power indicator

❸ Battery pack slot

❹ Power jack

❺ RJ45 connector

❻ USB Type C connector

❼ USB Type A port

Using the Battery

Installing and Removing the Battery

1. Carefully place the device upside down. Slide both battery cover latches inward towards the unlock (🔓) position. Lift up the battery cover from the opening and take it off the device.

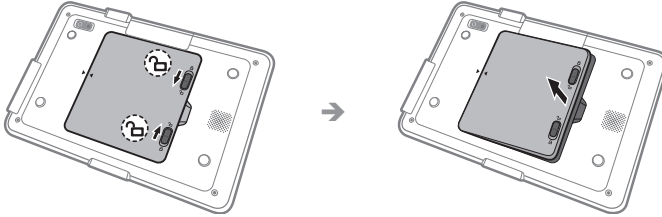

2. To install the battery: Insert the latch side of the battery pack into the battery compartment first (❶; indicated on the battery pack in blue **Insert battery - Step 1**), then gently push the battery pack inwards and downwards from the connector side (❷; indicated on the battery pack **Insert battery - step 2**). When the battery pack is installed in the battery compartment, push it leftwards to secure it into place (❸).

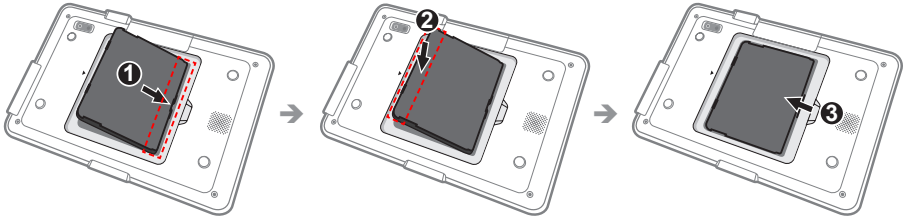

3. To remove the battery: Push the battery pack rightwards (❶), whilst simultaneously lift the battery out of the compartment (❷).

 The grips on the battery pack (the red circles as shown in the illustrations) help you push the battery pack easily.

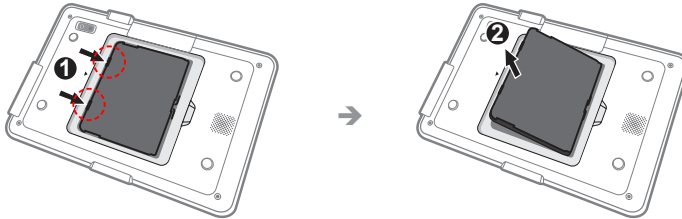

4. Align the triangular mark on the battery cover with the triangular mark on the device, and then close the battery cover properly. Push the up and bottom sides of the cover downwards to secure it in place, and then slide both battery cover latches outward towards the lock (🔒) position.

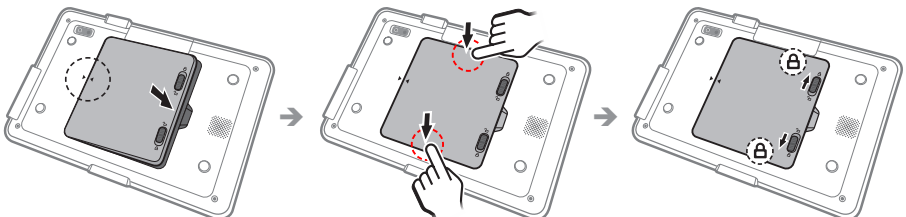

Charging the Battery

The battery is the internal power source for the device. It is rechargeable using the AC charger. Follow the instructions to charge the battery.

- ✎ The AC charger (12V/2A) may be sold separately.
- ✎ Use the specified charger for your device. Use of another type of charger may result in malfunction and/or danger.
- ✎ When charging the battery for the very first time, it is recommended to charge it for at least 8 hours (using the AC charger).

■ Charging the battery with the device

To charge the battery installed in the device, connect the AC charger to the device and an electrical outlet.

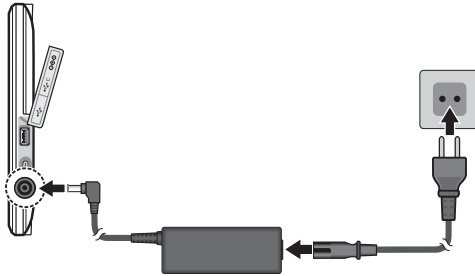

■ Charging the battery with the docking station

Depending on your model, a docking station may be provided for your device. Follow the illustrations below to install and use the docking station correctly.

1. Connect the power adapter to the docking station and an electrical outlet.

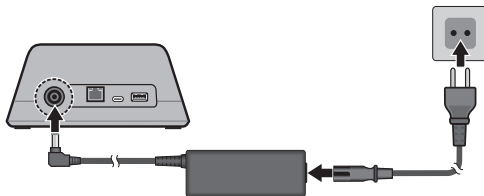

2. To charge a tablet, connect the tablet to the device connector on the docking station. Make sure that the tablet is seated properly in the docking station. The power indicator will glow in green on both the docking station and on the tablet.

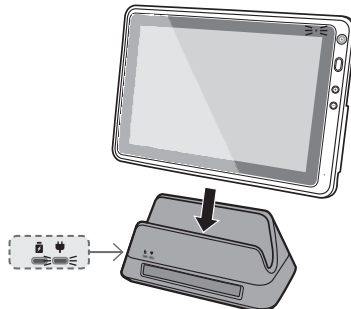

- ✎ To remove the tablet from the docking station, simply pull the tablet out of the slot in an upward motion.

3. To charge a battery, insert the battery into the battery slot with the label upwards and the battery connector side (indicated on the battery pack [Insert battery - step 2](#)) first. Press the battery pack firmly until you hear it click into place. The battery charge indicator will glow in red when the battery is charging; it will glow in green when the battery is fully charged.

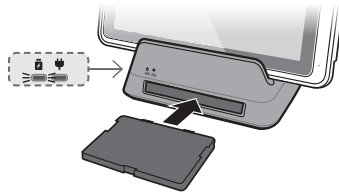

 To remove the battery from the slot, simply pull the battery out of the slot.

CAUTION!

For optimal performance of the lithium battery:

- Do not charge the battery where the temperature is high (for example, in direct sunlight).
- There is no need to fully discharge the battery.
- When storing the device/battery for a long period of time, be sure to charge the device at least once every two weeks. Over discharge of the device can affect the performance.
- Failure to follow the battery usage instructions may impair performance or cause damage to your device or battery. In extreme cases it may even lead to bodily injury or property damage, and will void any warranty.

Extending the Battery Life

There are various ways to improve the device's battery life.

- Always fully charge the battery.
- Turn on Battery saver (**Settings** → **Battery** → **Battery Saver**).
- Turn off unnecessary sounds, such as touch sounds.
- Close an app when you are not using it.
- Use a shorter timeout setting of the screen (**Settings** → **Display** → **Advanced** → **Sleep**).
- Lower the brightness level of the screen.
- Turn off Bluetooth when you are not using it.
- Prevent the device from constantly scanning for available wireless networks (**Settings** → **Network & internet** → **WIFI** → **WIFI preferences**).
- Enable Aeroplane mode to turn off all wireless transmission functions.

Using the Hot-swap Function

The hot-swap battery feature allows you to change the battery without turning off the device, saving valuable operating time. Follow the steps to replace the hot-swappable battery of your device.

1. Disconnect the device from any AC power source.
2. Press and hold the power button for 2 seconds to display the options menu, and then select **Hot swap battery**.
3. If prompted, tap **OK** and wait until the notification indicator on the top-right corner of the front side turns green.
4. Follow the instructions in the "Installing and removing the battery" section to replace the battery.
5. Press the power button to resume the device.



- ✎ To ensure optimal operations of the device, you are advised to complete the replacement within 30 minutes. If you have not used the device for a long time, you are advised not to use the Hot swap battery function until after 3 hours of powering on the device.
- ✎ If the device turns off during the procedure, press and hold the power button until the device turns on.

Using the Memory Card and Micro-SIM Card

1. Follow the instructions in the "Installing and removing the battery" section to remove the battery cover, and then remove the battery out of the battery compartment.
2. Locate the MicroSD card slot (as shown in the illustration). Hold the MicroSD card by the edges and gently insert it into the slot. Press until the SD-card clicks into place.
3. Depending on the model, your device may use a Micro-SIM card. Locate the Micro-SIM card slot (as shown in the illustration). Hold the Micro-SIM card by the edges and gently insert it into the slot. Press until the Micro-SIM clicks into place.

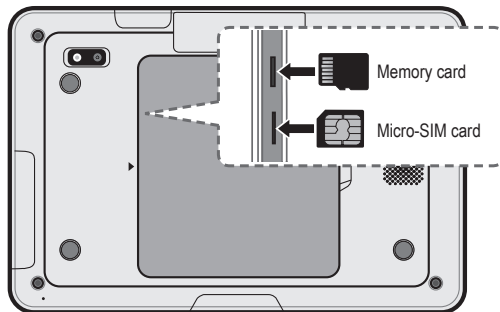

- ✎ Inserting the card in the reverse direction may cause damage.
 - ✎ To remove the card, gently push the top edge of the card inwards to release it, and pull it out of the slot.
 - ✎ To remove the memory card, first unmount it from the device: open the App drawer and tap **Settings** → **Storage** → **▲**. Then gently push the top edge of the card inwards to release it, and pull it out of the slot.
4. Replace the battery and the battery cover.

CAUTION!

- Do not apply pressure to the center of the memory card.
- The manufacturer does not guarantee the product's compatibilities with the storage cards from all manufacturers.
- If you encounter access problems with your memory card, please visit the website https://www.sdcard.org/downloads/formatter_4/ and use the "SD Memory Card Formatter 5.0 for SD/SDHC/SDXC" tool to format your memory card.

Turning the Device On and Off

Turning On

1. The device turns on automatically when it is powered. Wait for the boot screen to display.
2. The *Home* screen will display and the device is in Lock mode by default. Drag the Lock icon (🔒) upwards to unlock. The device is ready for use.

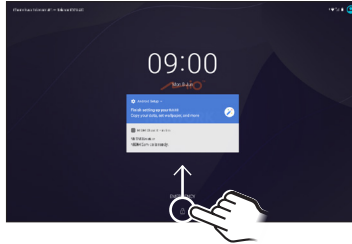

Sleep Mode

Your device will automatically switch off the screen after 1 minute (by default) of inactivity. You can manually switch off the screen by pressing the Power button briefly.

To resume the screen, press the Power button briefly and then unlock the device by dragging the Lock icon (🔒) upwards.

Aeroplane Mode

When you are using the device during air travel or in the area where data transferring is prohibited, enable Aeroplane mode. You will be able to use many of your device's applications, but all wireless radios, including wireless networks and Bluetooth, on the device are turned off.

To enable Aeroplane mode: open the App drawer and tap **Settings** → **Network & internet** → **Advanced**, then tap the **Aeroplane mode** switch to turn it on. The ✈️ icon in the status bar indicates that Aeroplane mode is on.

To disable Aeroplane mode: open the App drawer and tap **Settings** → **Network & internet** → **Advanced**, then tap the **Aeroplane mode** switch to turn it off.

📶 You can enable WIFI and Bluetooth in Aeroplane mode.

📶 You can turn the Aeroplane mode on or off from the Quick Settings.

Restarting the Device

You may need to reboot the device when the device is running slower or improperly. Press and hold the Power button to display the options menu and tap **Restart** to restart the device.

Turning Off

To turn off the device, press and hold the Power button to display the options menu and tap **Power off**.

Shutting Down

If the device stops responding, you may need to shut down the device by pressing and holding the Power button for 8 seconds in order to force a device reboot.

2. Getting Started

Using the Touch Screen

To operate your device, touch the screen with your finger. You can perform the following actions:

- **Tap:** Touch the screen once with your finger to open items or select on-screen buttons or options.
- **Tap and hold:** Tap and hold on the desired item to open the pop-up menu that contains the available options for the item.



- **Drag:** Tap and hold on the item and then move it to the target position without releasing your finger.
 - **Slide/Swipe:** Drag your finger vertically or horizontally across the screen.
 - Drag to the left/right to switch to the next/previous item on the list.
 - Drag to the top/bottom to scroll up/down the screen.
-  Not all slide gestures are applicable to all applications.

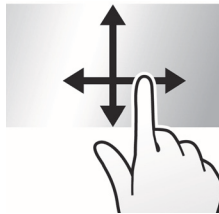

- **Two-finger gestures:** Move your fingers apart or together on the screen to zoom in or out while viewing a picture or a web page.
-  Not all two-finger gestures are applicable to all applications.



Rotating the Screen

For most applications, you can automatically change the screen orientation, from portrait to landscape and vice versa, by turning the device sideways.

To enable the auto-rotate screen function: open the App drawer by long-swiping from the home button upwards and tap **Settings** → **Display** → **Advanced**, then tap the **Auto-rotate screen** switch to turn it on.

- Rotating the screen is not applicable to all applications.
- You can also enable/disable the auto-rotate function in the Quick Settings menu (swipe down).

Home Screen

The *Home* screen is your starting place for tasks, providing quick access to frequently used applications and settings.

- To open the App drawer, swipe up from the bottom of the screen with one finger.
- To display the *Home* screen, tap the Home button (○) at any time.



Home Button

The Home button (○) returns to the desktop at any time.

Status Bar

The status bar is at the very top of the screen, displaying system status icons and notification icons.

Depending on your use of the device, some icons are not always shown in the status bar.

■ System status icons

The system status icons are displayed on the right side of the status bar. They provide information about your device's status, including the connection status, signal strength, battery power, and more.

■ Notification icons

The notification icons are displayed on the left side of the status bar. They report the arrival of new emails, calendar events, and other notifications.

When you see notification icons displayed in the status bar, you can open the Notifications panel to view the detailed descriptions. To open the Notifications panel, swipe down from the top of the screen with one finger.

From the Notifications panel, do one of the following:

- Tap a notification to open the related application.
- Tap **CLEAR ALL** to clear all notifications.

Desktop

The desktop includes the *Home* screen and the extended screens, providing useful information about notifications and device status. It also allows you to add an access to your favourite application shortcuts/widgets on the *Home* screen and the extended screens.

- Swipe left or right to switch between the screens.
- To add an extended screen: make sure that at least one application shortcut or widget is already set on the *Home* screen or an extended screen, then drag the icon toward the edge of the screen to add a new extended screen.

 An extended screen will be removed automatically when there are no longer any shortcuts or widgets placed on it.

Application Shortcuts and Widgets

The application shortcuts and the widgets can be placed on either the *Home* screen or any of the extended screens.

To add a shortcut:

1. Go to the screen where you want to place the shortcut.
2. Swipe up from the bottom of the screen to open the App drawer.
3. Tap and hold the desired app until the *Home* screen appears, drag it into place, and lift your finger.

To add a widget:

1. Go to the screen where you want to place the widget.
2. Tap and hold anywhere on the desktop, and select **Widgets**.
3. Scroll up and down to explore the available widgets.
4. Tap and hold the desired widget until the *Home* screen appears, drag it into place, and lift your finger.

To move a shortcut or widget to another position:

1. Tap and hold the icon, and drag the icon to the new position.
 - To move between the screens on the desktop, swipe toward the edge of the screen.
 - To bump another icon out of the way, slowly drag the desired icon into it.
2. Lift your finger.

To remove a shortcut or widget from the desktop (without removing it permanently from the device), tap and hold the icon, drag your finger toward the top-left corner of the screen, and drop it over **X** (Remove).

Favourites Tray

You can use the Favourites tray at the bottom of the desktop to quickly access your preferred apps.

You can edit the apps in the Favourites tray: simply tap and hold an icon and move it in or out of the Favourites tray or the desktop.

Grouping Shortcuts in a Folder

You can group the shortcuts to apps or settings on the desktop and the Favourites tray into a folder.

1. Tap and hold a shortcut, and then drag it over to another shortcut. A folder will be created automatically.
2. Tap to open the folder.
 - To add another shortcut to the folder, tap and hold the shortcut, and drag it over to the folder.
 - To remove a shortcut from the folder, tap and hold the shortcut, and drag it out of the folder.

3. To rename the folder, tap the title bar of the folder, and enter the desired folder name.
4. To delete the folder, tap and hold the folder, drag your finger toward the top of the screen, and drop it over **X** (Remove).

Changing the Wallpaper

1. Tap and hold anywhere on the desktop, and select **Wallpapers**.
2. Select a wallpaper image and tap **SET WALLPAPER**.

Quick Settings

Some frequently used settings can be found in Quick Settings. To open Quick Settings, simply swipe down from the top of the screen with two fingers or twice with one finger. Swipe left or right to access more settings.

Tap an icon to turn the function on or off; tap and hold an icon to change its setting.

- **WIFI**
- **Bluetooth**
- **Do not disturb**
Set how and when to receive notifications.
- **Auto-rotate**
Set the device's orientation to automatically rotate or lock in the portrait mode.
- **Battery Saver**
- **Mobile data**
See the cellular data usage, or turn it on or off.
- **Aeroplane mode**
- **Cast**

Your Apps

To see all your apps, swipe up from the bottom of the screen to open the App drawer.

You can place an app icon on any of the screens on the desktop. Tap and hold the app icon, then drag into the desired screen, and lift your finger.

To view information about an app, tap and hold the icon and then tap **i** (App info).

App Permissions

When you use some apps for the first time, you will be prompted to grant permissions for the apps to access certain data or features. To grant a permission, tap **Allow**; to reject a permission, tap **Deny**.

You can customise the permission settings of your apps in Settings:



1. Open the App drawer and tap **Settings** → **Apps & notifications** → **App permissions**.
2. Select an app to customise permission settings.

Barcode Reader

 This feature is for selected models only.

By using the Barcode Reader, your device will be able to read the information contained in the barcode.

Turning Barcode Reader On and Off

1. Open the App drawer and tap **BCR Settings** () .
2. Tap the **BCR Settings** switch to turn it on () or off () .

Using the Barcode Reader

1. Open the App drawer and tap **BCR Reader** () .
2. Position your device close to the barcode (approximately 5~10 cm) and point the barcode reader sensor to the barcode.
3. Do one of the followings to start scanning:
 - Press the Barcode reader button on the device (A); or
 - Tap the **SCAN** button of the BCR Reader application (B).

Meanwhile, hold your device steadily to keep the barcode within the sensor coverage until the information is displayed on the screen.

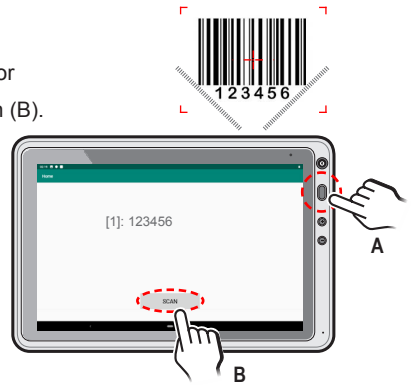

About the Barcode Reader

The following tables specify the supported symbologies and read ranges of the barcode reader.

Symbologies
Linear: UPC/EAN/JAN, GS1 DataBar, Code 39, Code 128, Code 32, Code 93, Codabar/NW7, Interleaved 2 of 5, Code 2 of 5, Matrix 2 of 5, MSI, Telepen, Trioptic, China Post
2D Stacked: PDF417, MicroPDF417, GS1 Composite
2D Matrix: Aztec Code, Data Matrix, QR Code, Micro QR Code, MaxiCode, Han Xin Cod
Postal: Intelligent Mail Barcode, Postal-4i, Australian Post, British Post, Canadian Post, Japanese Post, Netherlands (KIX) Post, Postnet, Planet Code
OCR Option: OCR-A, OCR-B, E13B (MICR)

Symbology	Extended Range (Typical)	
	Start (mm/[in])	Stop (mm/[in])
C39 5mil	96,5 [3.8]	283 [11.1]
C39 10mil	72 [2.8]	551 [21.7]
UPC-A 13mil	51 [2.0]	559 [22.0]
C39 20mil	56 [2.2]	819 [32.2]
PDF 417 6.7mil	127 [5.0]	232 [9.1]
QR 20mil	45 [1.8]	516 [20.3]
DM 10mil	120 [4.7]	282 [11.1]

 Barcode quality and environmental conditions may affect performance.

Using the Keyboard

When you select a field that requires text or numbers, the on-screen keyboard will automatically appear. You can use the on-screen keyboard to enter text, numbers, symbols, etc.

Some apps open the keyboard automatically. In others, tap where you want to type to open the keyboard.

As you type, predictive suggestions for completing each word appear above the keyboard.

Basic Editing

■ To change where you want to type:

Tap the screen once in the position where you want to type and the typing symbol will move to the new position.

■ To select text:

1. Tap and hold (or double-tap) within the text.
2. The nearest word highlights, with a tab at each end of the selection. Drag the tabs to change the selection.











■ To delete text:

Tap  to delete the characters before the cursor or selected text.



■ To cut, copy or paste text:

1. Select the text you want to cut or copy, and tap **Cut** or **Copy**.
2. Tap where you want to paste the text, and tap **Paste**.

■ To type capital letters:

- To type one capital letter, tap  on the keyboard until it turns to .
- To type multiple capital letters, tap and hold (or double-tap quickly)  to turn it to  (caps lock is turned on).
- To quickly change the capitalisation of a word you have already typed, select it and tap the  /  / .
- To type lowercase letters, tap  /  once to turn it to .



■ To type a symbol:

1. Tap .
2. To view additional symbols, tap .
3. Tap  to return to the keyboard.

■ To type an accented characters (not applicable to all apps):

Tap and hold the letter. When the suggestions appear above the keyboard, slide to the desired accented character and lift your finger.

■ To use emoji (not applicable to all apps):

1. Tap . You will see the emoji symbols.
2. Scroll up and down to view and select the desired emoji.
3. Tap  to return to the keyboard.

Adding Your Email Accounts

 This requires an Internet connection.

You need to set up an account on your device to use the Calendar and Email apps. You can set up multiple accounts.

1. Open the App drawer and tap **Settings** → **Accounts**.
2. Tap **Add account**.
3. Select the type of account that you want to add.
4. Follow the on-screen instructions to add the account.

By default, the auto-sync function of your account is enabled. Tap the **Automatically sync data** switch to turn the function on or off.

Removing an Account

When you remove an account that you have added to your device, everything associated with that account, including email, contacts, calendar events and settings, is also deleted.

1. Open the App drawer and tap **Settings** → **Accounts**.
2. Select the account and tap **REMOVE ACCOUNT** to remove.

3. Connectivity

Cellular Data Connection

 This feature is not available on all models.

To use cellular services, you must insert a Micro-SIM card with an active data subscription plan from a mobile network provider. In most cases, the settings of the cellular services are installed automatically.

To turn cellular services on/off:

1. Open the App drawer and tap **Settings** → **Network & internet** → **Mobile network**.
2. Tap the **Mobile data** switch to turn it on or off.

If you are on a limited data allowance, you can monitor the data usage on the device: open the App drawer and tap **Settings** → **Network & internet** → **Mobile network** → **Data usage**.

 Turn off the cellular services when not in use to save battery power.

 Mobile data can also be turned on/off through the Quick Settings menu.

Wireless Network Connection

To access data services through a wireless local area network (WIFI) on your device, you need to connect to a wireless access point (AP) or "hotspot".

 The coverage of the WIFI signal can be up to 300 feet (100 metres). However, coverage, speed and connection stability varies greatly due to external factors such as building infrastructure and other objects which may interfere with the WIFI signal.

Connecting to a Wireless Network

1. Open the App drawer and tap **Settings** → **Network & internet**.
2. Tap the **WIFI** switch to turn it on. The device will automatically scan for available wireless networks.
3. Tap a wireless network to connect.
4. If you select an open network, you will be automatically connected to the network. If you select a secured network, enter the key and then tap **CONNECT**.
5. When your device is connected to a wireless network, the WIFI icon () will appear in the status bar.

The next time your device connects to a previously accessed secured wireless network, you will not be prompted to enter the key again, unless you reset the network settings or reset your device to its factory default settings.

 Turn off the WIFI function when not in use to save battery power.

 WIFI settings can also be turned on/off through the Quick Settings menu.

Removing a Remembered Network

1. Open the App drawer and tap **Settings** → **Network & internet** → **WIFI**.
2. Tap and hold the network to remove on the list, and select **Forget network**.

Bluetooth

Bluetooth is a short-range wireless communications technology that allows Bluetooth-enabled devices to exchange information over a distance of about 30 feet (10 metres) without requiring a physical connection.

Pairing with Another Bluetooth Device

1. Make sure that the Bluetooth function of the other device is turned on.
2. Open the App drawer and tap **Settings** → **Connected devices** → **Pair new device**.
3. The device will automatically scan for available Bluetooth devices.
4. Tap the desired device from the list to initiate pairing.
5. Make sure that the same passkey is displayed on your device and the other device, and then tap **PAIR**.

 Turn off the Bluetooth function when not in use to save battery power.

Disconnecting a Bluetooth Connection

1. Open the App drawer and tap **Settings** → **Connected devices**.
2. Tap the desired paired device.
3. When prompted to disconnect, tap **OK**.



NFC

 This feature is not available on all models.

The Near Field Communication (NFC) feature allows you to easily transfer data to an NFC-compatible device, read and write information to contactless cards and NFC-compatible devices, and more.

The NFC area is located at the lower right corner of the device's front panel. The distance of the two devices to communicate should be within the range of 4 cm.

Turning NFC On and Off

1. Open the App drawer and tap **Settings** → **Connected devices** → **Connection preferences**.
2. Tap the **NFC** switch to turn it on () or off ().

Using NFC

■ Transferring Data Using NFC

1. Access the data you want to share, access the share options, and tap **Android Beam**.
2. Touch the screen of your device.
3. Hold the lower right corner of your device close to the NFC sensor of the other device.
4. Pay attention to and accept the beam notification on the other device.

■ Reading a NFC Card

You can use your device to read NFC cards. Simply launch the NFC-enabled application (not included) and then move the contactless card close to the NFC sensor of the device. Keep holding the card until the transaction is complete.

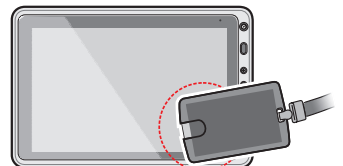

4. Personalising Your Device

You can easily customise the device for personal settings through the Settings menu, such as personalising the *Home* screen, changing the display and sound settings, configuration the connection settings, and more.

 Not all setting items and options are available for all models.

Settings Menu

To access the Settings menu, do one of the following:

- Open the App drawer and tap **Settings**.
- Slide down from the top of the screen with two fingers or twice with one finger to open Quick Settings, and tap .

 Tap **Advanced** to access more setting options.

Network & internet

■ WIFI

See the "Wireless Network Connection" section in the "Connectivity" chapter for information.

■ Mobile network

See the "Cellular Data Connection" section in the "Connectivity" chapter for information.

■ Data usage

You can enable and monitor the data usage on the device. This is useful if you are on a limited data allowance.

■ Hotspot & tethering

You can share your device's mobile data with another smart device. This is called tethering or using a hotspot.

- **WIFI Hotspot:** When enabled, you can use the device as a WIFI hotspot to connect (up to 10) other devices. On the other device, enable the WIFI function and select your device's hotspot name. Enter the hotspot password and tap **Connect**.
- **USB tethering:** Use the USB-C port to connect another device (like a laptop) to your device to share its data connection.
- **Bluetooth tethering:** Connect the two devices via Bluetooth. Make sure that the checkbox of the "Internet access" option is selected in the settings of the Bluetooth connection.

■ SIM cards

You can enable or disable a SIM card (if **SIM 2** is available) and select which SIM card you prefer for Data use, Calls use, SMS use.

■ Mobile plan

You may be able to access the website to view the mobile plan of your service provider. (This feature may not be supported on all models.)

■ Aeroplane mode

See the "Aeroplane Mode" section in the "Device Basics" chapter for information.

■ VPN

You can use a virtual private network (VPN) to access the Internet with more security and privacy. A VPN may also get around regional restrictions.

To set up a VPN connection, tap +, enter the details of the VPN and tap **Save**. Tap the VPN to connect, enter the required username and password, select the checkbox for **Save account information**, and tap **Connect**.

■ Private DNS

Select **Off**, **Automatic**, or **Private DNS provider hostname** to enter a hostname if you want to use a private DNS provider.

Connected devices

■ Pair new device

See the "Bluetooth" section in the "Connectivity" chapter for information.

■ Connection preferences

The setting option allows you to set connection preferences.

- USB Host
- Bluetooth
- NFC
- Android Beam
- Cast
- Printing
- Received files
- Chromebook

Apps & notifications

Here you find an overview of the installed apps on your device. You can click on any app to view further details such as permission settings, notification settings, storage settings and data usage. You can also disable or uninstall apps from this screen.

Battery

You can view the percentage and time of the remaining battery power since the last full charge.

You can turn on the Battery Saver feature to help conserve battery power. Tap **Battery Saver** and tap the **Turn on automatically** switch to turn it on, then set when to turn it on automatically.

Display

■ Brightness level

Move the slider to adjust the brightness level of the device.

■ Night Light

The Night Light feature makes it easier on your eyes to look at the screen and read in dim light.

You can activate Night Light mode by tapping **TURN ON NOW**; or set times by tapping **Schedule** and then select **Turns on at custom time** or **Turns on from sunset to sunrise**.

■ Adaptive brightness

When enabled, this can automatically optimise the brightness level of the device based on the ambient light conditions around you.

■ Wallpaper

Change the wallpaper of the desktop.

■ Sleep

Change the screen time-out setting.

■ Auto-rotate screen

When this item is enabled, the screen rotates automatically based on the device orientation.

■ Font size

Select the desired font size.

■ Display size

Select the desired size for the items on your screen.

■ Screen saver

Set the screensaver when the device is charging or docked.

■ Ambient display

The Ambient display feature will automatically wake up your screen when new notifications are received. Tap the **New notifications** switch to turn it on or off.

■ Device theme

Select the desired mode for the device theme: **Automatic**, **Light** or **Dark**.

 The Dark theme mode applies to both the system display and apps running on the device.

Sound

Move the slider to adjust the sound level for media playback, alarms and notifications.

■ Do not disturb

Set how and when to receive notifications.

■ Shortcut to prevent ringing

Tap **Press Power & Volume Up together** to select the desired model: **Vibrate**, **Mute** or **Do nothing**.

■ Phone ringtone

You can set the custom ringtones for incoming calls.

■ Default notification sound

Select the desired default notification sound of the device.

■ Default alarm sound

Select the desired default alarm sound of the device.

■ Other sounds and vibrations

Enable or disable **Dial pad tones**, **Screen locking sounds**, **Charging sounds**, **Touch sounds** and **Touch vibrate**.

Storage

The storage options of you device include the device internal storage and a removable MicroSD card (if inserted).

Security & location

■ Security status

- **Google Play Protect:** Check the safety status of the apps.
- **Find My Device:** This feature allows you to find your device if it gets lost.

■ Device security

Set the **Screen lock** setting when the screen enters the sleep mode or when you press the power button. This can protect your personal information.

- None
- Swipe
- Pattern
- PIN
- Password

■ Privacy

- **Location:** You can turn the location services on or off, and set the location mode.
- **Show passwords:** When enabled, the characters of your passwords will not be hidden.

■ Device admin apps

View or remove the apps that can administer the device.

■ Screen pinning

Screen pinning is a feature that enables you to only show a specific app screen. This means all other functions of the phone are locked, apart from the one app that is pinned. This is useful if you want to limit user access to a specific app or task only.

Accounts

You can set up multiple accounts for services like email. Tap **Add account** to add an account on your device.

Accessibility

The system provides one tap access to many features such as sound and display assistant tools. Select the desired setting option and tap the **Use service** switch to turn it on or off.

Digital Wellbeing & parental controls

Use the setting options to get controls and features that work for any moment during the day, helping you control how and when you use your device.

Google

Set the Google services and preferences.

System

■ Languages & input

- **Language:** Change the display language.
- **Virtual keyboard:** Set the virtual keyboard settings.
- **Physical keyboard:** Set the physical keyboard settings.
- **Spell checker:** When enabled, you can tap on a misspelled word to get a list of suggested replacements.

- **Autofill service:** Select the desired service to enable the feature that allows you to easily fill out forms.
- **Personal dictionary:** Add your own words to your personal dictionary so that your device remembers them.
- **Pointer speed:** Change the speed of scrolling.
- **Text-to-speech output:** Customise the text-to-speech settings.

■ Gestures

Enable or disable gesture-based navigation: **Jump to camera**, **Swipe up on Home button** and **Prevent ringing**.

■ Date & time

You can change the date and time, and time zone of your device.

■ Backup

Enable or disable the **Back up to Google Drive** feature.

■ Reset options

- **Reset WIFI, mobile & Bluetooth:** Reset the settings for mobile data, WIFI and Bluetooth when you encounter connection problems.
- **Reset app preferences:** Reset the apps configuration.
- **Reset all data (factory reset):** Delete all data and settings from the device. Back up your data before performing a factory data reset.

■ Multiple users

The system supports multiple users on a single device by separating user accounts and application data. Each user profile has an individual space on the device for custom Home screens, accounts, apps, settings, and more.

Tap **Add user** to add a user on your device.

■ System update

Check for available system updates.

About phone

You can view the device and software information.

5. Reference

Specifications and Accessories

Specifications

Refer to the following table for the specifications of L100x/L104x Series.

Model Name	L1000	L1005	L1040	L1045
Display	10.1" (600 nits)			
Resolution	1280x800			
4G/WIFI	WIFI		4G LTE Cat.6	
OS	Android 9.0			
GMS	GMS			
CPU	Qualcomm SDM450 Octa, 1.8 GHz			
RAM / Internal Storage	2G/16G		2G/32G (4G/64G opt.)	
SIM	N/A		MicroSIM (SIM 1) eSIM (SIM 2, opt.)	
GPS	N/A		GPS + GLONASS	
BCR	N/A	Honeywell N6603 ER	N/A	Honeywell N6603 ER
Sensor	Accelerometer Gyro Ambient light Vibration motor		Accelerometer Gyro Ambient light Vibration motor eCompass Barometer Thermal sensor	

Accessories

The optional accessories may improve your user experience of the device. The accessories are available on the website: enterprise.mio.com

■ Adapter

This unit is supplied by an UL Listed power supply suitable for used at Tma 45 degree C and operated altitude at minimum 2000 m whose output meets SELV, and is rated 12Vdc, 2.0A.

Please purchase the approved power source that is certified by an IEC or UL through the specified dealer.

If you have any questions or need more information about your product, please contact your sales representative or the manufacturer.

■ Battery Pack

Please purchase the approved battery pack (manufactured by Getac Technology Corp. model N630) through the specified dealer.

If you have any questions or need more information about your product, please contact your sales representative or the manufacturer.

Troubleshooting

For initial support, contact your IT department or your local authorised dealer.

■ Power does not switch on when using battery power.

The remaining battery power may be too low to run your device. Charge the battery.

■ Screen responds slowly.

Make sure that your device is not running out of battery power. If the problem still persists, restart your device.

■ Screen freezes.

Restart your device.

■ Screen is hard to read.

Make sure that the backlight of the display is set to a high-enough brightness.

■ Cannot establish a connection with a computer.

- Make sure that your device and your computer are both switched on before trying to establish a connection.
- Make sure your device has "USB Client" mode enabled. You can find this feature under **Settings → Connected devices → Connection preferences**.
- Make sure that the cable is securely plugged into the USB port on your computer and on your device. Connect the USB cable directly to your computer—do not run the cable through a USB hub.
- Restart your device before connecting the cable. Always disconnect your device before you restart your computer.

Caring for the Device

Taking good care of your device will ensure trouble-free operation and reduce the risk of damage to your device.

- Keep your device away from excessive moisture and extreme temperatures.
- Avoid exposing your device to direct sunlight or strong ultraviolet light for extended periods of time.
- Do not place anything on top of your device or drop objects on your device.
- Do not drop your device or subject it to severe shock.
- Do not subject your device to sudden and severe temperature changes. This could cause moisture condensation inside the unit, which could damage your device. In the event of moisture condensation, allow the device to dry out completely before use.
- The screen surface can easily be scratched. Avoid touching it with sharp objects. Non-adhesive generic screen protectors designed specifically for use on portable devices with LCD panels may be used to help protect the screen from minor scratches.
- Never clean your device with it powered on. Use a soft, lint-free cloth to wipe the screen and the exterior of your device.
- Do not use paper towels to clean the screen.
- Never attempt to disassemble, repair or make any modifications to your device. Disassembly, modification or any attempt at repair could cause damage to your device and even bodily injury or property damage and will void any warranty.

- Keep your device and its accessories out of the reach of small children or animals.
- Do not store or carry flammable liquids, gases or explosive materials in the same compartment as your device, its parts or accessories.
- To discourage theft, do not leave the device and accessories in plain view in an unattended vehicle.
- Do not leave the device and its accessories in a vehicle in direct sunlight. Overheating may damage the device.
- The device (excluding accessories) is protected again splashes, water and dust. When tested under controlled laboratory conditions, the device is compliant with the IP67 rating of the IEC 60529 standard. The manufacturer guarantees this grade provided all jack covers are properly and securely closed. Immersion in water or water-pressure such as washing the unit with running water may cause damage to the unit and voids warranty. Normal wear might decrease resistance. The device should not be operated in water.

Cleaning and Disinfecting Guide

Thousands of field workers around the world use rugged MioWORK™ tablets & handhelds in diversified environments such as hospitals, restaurants, routes, warehouses, and more. Nevertheless, some critical conditions may cause the risk of damage to devices or the possibility of infections due to environmental contamination. Fortunately, these can be prevented from routine cleaning and disinfecting devices for not only worker safety and health but also prolonging the life of the devices.

Following the instructions:

1. Turn off the device and ensure battery is installed and back cover (if has) is properly locked.
2. Wipe all surfaces of the device with the moistened Lint-free cloth following the disinfectant manufacturer's instructions for use.
3. Use a cotton swab moistened by a disinfectant to clean the buttons and other recessed areas of the device.
4. Leave the device to completely air dry before turning on the power or placing it in a cradle/docking station.

Suggested Disinfectants:

Name	Manufacturer	Active Ingredient
Isopropyl Alcohol 75%	Multiple Manufacturers	Alcohol
CaviWipes	Metrex	Alcohol (17.20%)
Clean-Up	Clorox	Sodium Hypochlorite
Oxivir® Tb Wipes	Diversey	Hydrogen Peroxide

 Please refer to the instructions provided by the disinfectant manufacturer.

Antimicrobial Housing Designed for Healthcare & Hospitality

Infection control in healthcare facilities and restaurants is big business. MioWORK™ L100x/L104x Series product lines are adopted the inorganic antimicrobial agent - IONPURE®, certified by US FDA & EPA and EU BPR, which provides extraordinarily sterilizing power and keeps the antibacterial effect for a long time. Passing strict JIS Z 2801 test for antimicrobial activity of materials, MioWORK™ L100x/L104x Series empowers front-line staffs to work safely and efficiently.

Regulatory Information

For regulatory identification purposes, the product is assigned a model number of N630.

Marking labels located on the exterior of your device indicate the regulations that your model complies with. Please check the marking labels on your device and refer to the corresponding statements in this chapter. Some notices apply to specific models only.

5GHz band (W52,W53): Indoor use only

RCM



EAC



FCC



Federal Communication Commission Interference Statement

This equipment has been tested and found to comply with the limits for a Class B digital device pursuant to Part 15 of the FCC Rules. These limits are designed to provide reasonable protection against harmful interference in a residential installation. This equipment generates, uses, and can radiate radio frequency energy and, if not installed and used in accordance with the instructions, may cause harmful interference to radio communications. However, there is no guarantee that interference will not occur in a particular installation. If this equipment does cause harmful interference to radio or television reception, which can be determined by turning the equipment off and on, the user is encouraged to try to correct the interference by one or more of the following measures:

- Reorient or relocate the receiving antenna.
- Increase the separation between the equipment and receiver.
- Connect the equipment into an outlet on a circuit different from that to which the receiver is connected.
- Consult the dealer or an experienced radio/TV technician for help.

Any changes or modifications not expressly approved by the manufacturer could void the user's authority to operate the equipment.

This device complies with part 15 of the FCC Rules. Operation is subject to the following two conditions: (1) This device may not cause harmful interference, and (2) this device must accept any interference received, including interference that may cause undesired operation.

Please note: The use of a non-shielded interface cable with this equipment is prohibited.

USA Contact Information

Magellan
279 E Arrow Highway San Dimas, CA 91773 USA
+1 909-394-5000
<http://www.magellangps.com>

IC

Canadian Department Of Communications
CAN ICES-3(B)/NMB-3(B)

Radio Interference Regulations Class B Compliance Notice

This Class B digital apparatus meets all requirements of the Canada Interference-Causing equipment regulations.

Cet appareil numérique de Classe B respecte toutes les exigences du Règlement Canadien sur le matériel brouilleur.

This device complies with Industry Canada's licence-exempt RSSs. Operation is subject to the following two conditions:

- (1) This device may not cause interference; and
- (2) This device must accept any interference, including interference that may cause undesired operation of the device.

Le présent appareil est conforme aux CNR d'Industrie Canada applicables aux appareils radio exempts de licence. L'exploitation est autorisée aux deux conditions suivantes:

- (1) l'appareil ne doit pas produire de brouillage, et
- (2) l'utilisateur de l'appareil doit accepter tout brouillage radioélectrique subi, même si le brouillage est susceptible d'en compromettre le fonctionnement."

The device could automatically discontinue transmission in case of absence of information to transmit, or operational failure. Note that this is not intended to prohibit transmission of control or signaling information or the use of repetitive codes where required by the technology.

The device for operation in the band 5150–5250 MHz is only for indoor use to reduce the potential for harmful interference to co-channel mobile satellite systems.

High-power radars are allocated as primary users (i.e. priority users) of the bands 5250–5350 MHz and 5650–5850 MHz and that these radars could cause interference and/or damage to LE-LAN devices.

L'appareil peut interrompre automatiquement la transmission en cas d'absence d'informations à transmettre ou de panne opérationnelle. Notez que ceci n'est pas destiné à interdire la transmission d'informations de contrôle ou de signalisation ou l'utilisation de codes répétitifs lorsque cela est requis par la technologie.

Le dispositif utilisé dans la bande 5150-5250 MHz est réservé à une utilisation en intérieur afin de réduire le risque de brouillage préjudiciable aux systèmes mobiles par satellite dans le même canal.

CE



- WWAN:33dBm
- BT:10.5dBm
- WiFi 2.4G:16dBm
- WiFi 5G:15dBm
- NFC:-3.29 dBuA/m@ 10m

Products with the CE marking comply with Radio Equipment Directive (Directive 2014/53/EU) - issued by the Commission of the European Community.

Compliance with these directives implies conformity to the following European Standards:

- EN 62311
- EN 62209-2
- EN 50566
- EN 301 489-1/-3/-17/-19/-52
- EN 55032
- EN 55035
- EN 61000-3-2

- EN 61000-3-3
- EN 300 328: BT/WLAN 2.4 GHz
- EN 301 893: WLAN 5 GHz
- EN 300 330: RFID/NFC
- EN 303 413: GPS
- EN 301 511: GSM 900/1800
- EN 301 908-1/-13
- IEC62368-1:2014
- UL 62368-1, 2nd Edition, 2014-12-01

The device is restricted to indoor use only when operating in the 5150 to 5350 MHz frequency range.

	AT	BE	BG	HR	CY	CZ	DK
	EE	FI	FR	DE	EL	HU	IE
	IT	LV	LT	LU	MT	NL	PL
	PT	RO	SK	SI	ES	SE	UK

 The DoC letter will be added to the end of the manual.

RF Exposure Information (SAR)

This device has been tested and meets applicable limits for Radio Frequency (RF) exposure. Specific Absorption Rate (SAR) refers to the rate at which the body absorbs RF energy. SAR limits are 1.6 Watts per kilogram (over a volume containing a mass of 1 gram of tissue) in countries that follow the United States FCC limit and 2.0 W/kg (averaged over 10 grams of tissue) in countries that follow the Council of the European Union limit. Tests for SAR are conducted using standard operating positions with the device transmitting at its highest certified power level in all tested frequency bands. To reduce exposure to RF energy, use a hands-free accessory or other similar option to keep this device away from your head and body. Carry this device at least 10 mm away from your body to ensure exposure levels remain at or below the as-tested levels. Choose the belt clips, holsters, or other similar body-worn accessories which do not contain metallic components to support operation in this manner. Cases with metal parts may change the RF performance of the device, including its compliance with RF exposure guidelines, in a manner that has not been tested or certified, and use such accessories should be avoided.

WEEE



This symbol means that according to local laws and regulations your product and/or its battery shall be disposed of separately from household waste. When this product reaches its end of life, take it to a collection point designated by local authorities. Proper recycling of your product will protect human health and the environment.

Bluetooth



DID: D046978

Safety Precautions

When using the device, note that the ambient temperature should be below 45°C (113°F).



To prevent possible hearing damage, do not listen at high volume levels for long periods of time.



LASER LIGHT - DO NOT STARE INTO BEAM
RAYONNEMENT LASER NE PAS REGARDER DANS LE FAISCEAU.

■ About Charging

- Use only the charger supplied with your device. Use of another type of charger will result in malfunction and/or danger.
- This product is intended to be supplied by a LISTED Power Unit marked with "LPS", "Limited Power Source" and output rated + 12 V dc / 2.0 A.
- Use a specified battery in the equipment.

■ About the Charger

- Do not use the charger in a high moisture environment. Never touch the charger when your hands or feet are wet.
- Allow adequate ventilation around the charger when using it to operate the device or charge the battery. Do not cover the charger with paper or other objects that will reduce cooling. Do not use the charger while it is inside a carrying case.
- Connect the charger to a proper power source. The voltage requirements are found on the product case and/or packaging.
- Do not use the charger if the cord becomes damaged.
- Do not attempt to service the unit. There are no serviceable parts inside. Replace the unit if it is damaged or exposed to excess moisture.

■ About the Battery

- Use a specified battery in the equipment.
- CAUTION: This unit contains a Lithium Ion battery. The battery can burst or explode, releasing hazardous chemicals. To reduce the risk of fire or burns, do not disassemble, crush, puncture, or dispose of in fire or water.
- Important instructions (for service personnel only)
 - Caution: Risk of explosion if battery is replaced by an incorrect type. Dispose of used batteries according to the instructions.
 - Replace only with the same or equivalent type recommended by the manufacturer.
 - The battery must be recycled or disposed of properly.
 - Use the battery only in the specified equipment.